

sostegni e fissaggi | supports and fasteners

INDICE | **INDEX**

Note tecniche	2	<i>Technical informations</i>
Sostegno verticale asolato	4	<i>Holed vertical support</i>
Sostegno verticale semplice	5	<i>Simple vertical support</i>
Sostegno verticale doppio	6	<i>Double vertical support</i>
Sostegno orizzontale	7	<i>Horizontal support</i>
Fissaggio sostegno verticale	9	<i>Vertical support fastener</i>
Staffa fissaggio tubi per PTR	15	<i>Pipe fixing brackets for PTR</i>
Staffa fissaggio tubi per PFR	15	<i>Pipe fixing brackets for PFR</i>
Staffa fissaggio tubi per PTR/PFS	15	<i>Pipe fixing brackets for PTR/PFS</i>
Morsetto fissatubo	16	<i>Pipe fastening clamp</i>
Gaffetta	16	<i>Collar</i>
Cavalotto	17	<i>U bolt</i>
Piastrina per fissaggio piatto di terra	17	<i>Fixing plate for earth bar</i>
Bullone fissaggio sostegni	17	<i>Support fixing bolt</i>
Vite a testa esagonale	18	<i>Exagon head screw</i>
Rondella piana	18	<i>Washer</i>
Rondella elastica	19	<i>Serrated lock washer</i>
Dado	19	<i>Nut</i>
Barra filettata	19	<i>Threaded rod</i>
Tassello ad espansione	20	<i>Screw anchor</i>
Vernice per ritocchi a base di zinco	20	<i>Touch-up paint of zinc</i>
Piatto	20	<i>Plate</i>
Angolare	21	<i>Equal angular</i>
Ferro ad "U"	21	<i>U iron</i>
Tubo conduit	21	<i>Conduit</i>

INTRODUZIONE

La lunga esperienza nel settore dei montaggi industriali ha portato a studiare e realizzare tutta una serie di ancoraggi e staffaggi che consentono un facile e rapido utilizzo senza la necessità di attrezzature particolari.

SITIE da anni lavora in regime di qualità; a garanzia dei propri prodotti e servizi ha ottenuto le certificazioni per la qualità, ambiente e sicurezza ISO 9001-2000, ISO 14001 e OHSAS 18001.

Il materiale generalmente usato per la costruzione dei profili è S275JR (UNI EN-10025) zincato a caldo per immersione dopo la lavorazione secondo norme CEI 7.6.

I profilati doppi vengono realizzati con l'unione, a mezzo saldatura con procedimento MAG.

I profilati semplici possono essere realizzati pieni o con asole 9x30 mm sulla base.

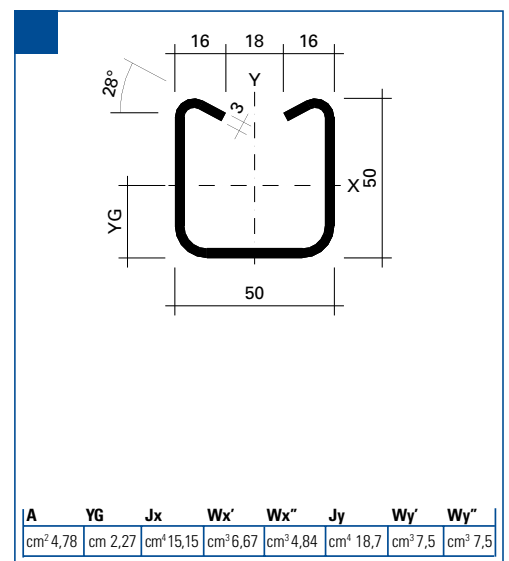
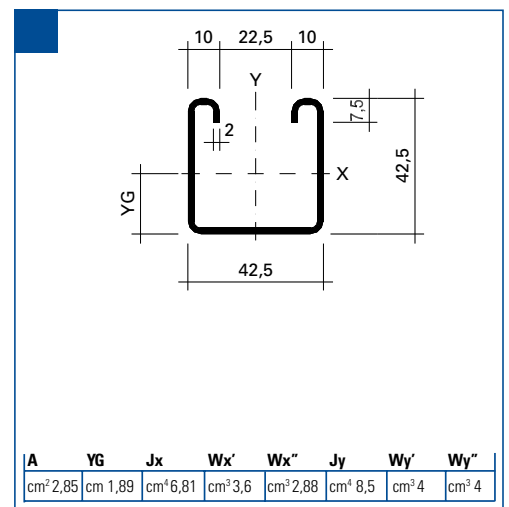
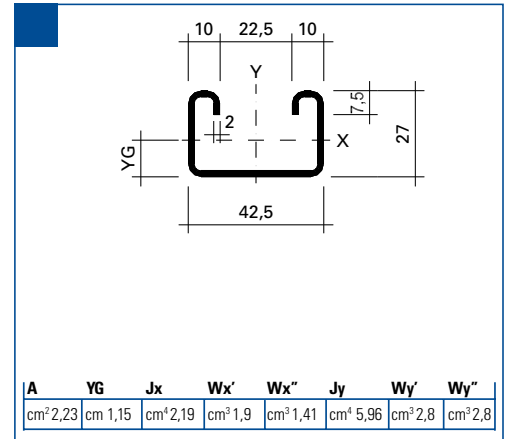

[note tecniche]

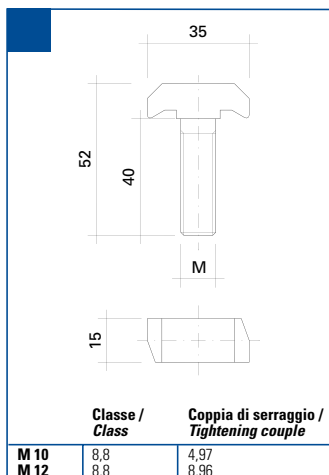

Bullone fissaggio sostegni.
Support fixing bolt.

INTRODUCTION

Our long experience in the field of industrial installations has permitted to design and carry out many types of anchor fixings and brackets which allow an easy and fast use without any kind of special tools.

SITIE has been working for several years under quality control systems, and obtained ISO 9001-2000, ISO 14001 and 18001 certifications for quality, environment and safety, which guarantee the reliability of our products and services.

They are made of carbon steel S275JR (UNI EN-10025) hot dip galvanized after working according to CEI standard 7.6.

Double section profiles are obtained by MAG welding process of two single steel sections.

Single profiles can be manufactured solid type or with slots 9x30mm.

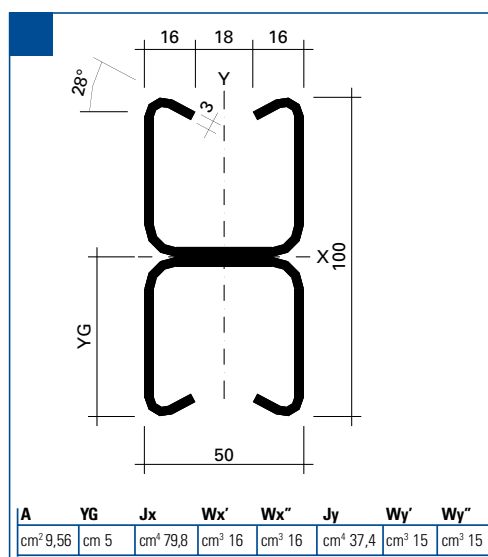
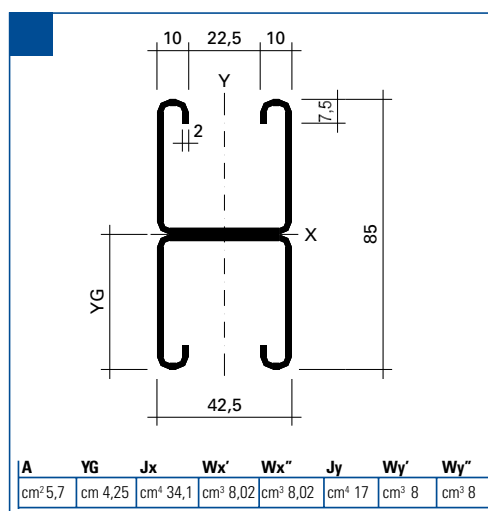
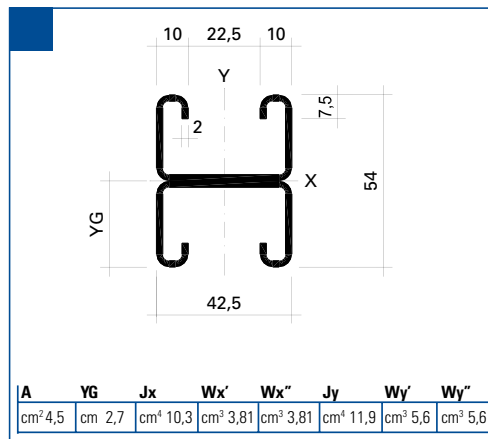

[sostegno verticale asolato | holed vertical support]

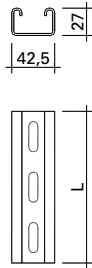

ELEMENTO ELEMENT	CODICE CODE		AISI 304	AISI 316	-
Descr.	L	Th	HDG		
SV-F/42x27/3000	3000	2	SOVF3027	*	- - -
SV-F/42x27/6000	6000	2	SOVF6027	*	- - -

* A richiesta. - On request.



ELEMENTO ELEMENT	CODICE CODE		AISI 304	AISI 316	-
Descr.	L	Th	HDG		
SV-F/42x42/3000	3000	2	SOVF3042	*	- - -
SV-F/42x42/6000	6000	2	SOVF6042	*	- - -

* A richiesta. - On request.

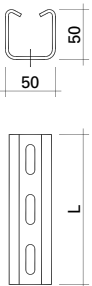

ELEMENTO ELEMENT	CODICE CODE		AISI 304	AISI 316	-
Descr.	L	Th	HDG		
SV-F/50x50/3000	3000	3	SOVF3050	*	- - -
SV-F/50x50/6000	6000	3	SOVF6050	*	- - -

* A richiesta. - On request.

[sostegno verticale semplice | simple vertical support]

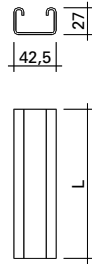

ELEMENTO | ELEMENT

CODICE | CODE

Descr.	L	Th	HDG	AISI 304	AISI 316	-
SV-S/42x27/3000	3000	2	SOVS3027	*	*	- - -
SV-S/42x27/6000	6000	2	SOVS6027	*	*	- - -

* A richiesta. - On request.

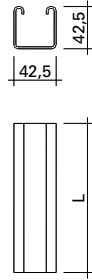

ELEMENTO | ELEMENT

CODICE | CODE

Descr.	L	Th	HDG	AISI 304	AISI 316	-
SV-S/42x42/3000	3000	2	SOVS3042	*	*	- - -
SV-S/42x42/6000	6000	2	SOVS6042	*	*	- - -

* A richiesta. - On request.

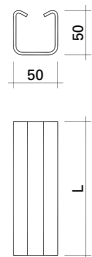

ELEMENTO | ELEMENT

CODICE | CODE

Descr.	L	Th	HDG	AISI 304	AISI 316	-
SV-S/50x50/3000	3000	3	SOVS3050	*	*	- - -
SV-S/50x50/6000	6000	3	SOVS6050	*	*	- - -

* A richiesta. - On request.

[sostegno verticale doppio | double vertical support]

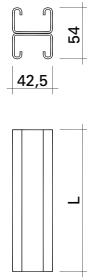

ELEMENTO | ELEMENT

CODICE | CODE

Descr.	L	Th	HDG	AISI 304	AISI 316	-
SV-D/42x27/3000	3000	2	SOVD3027	*	*	- - -
SV-D/42x27/6000	6000	2	SOVD6027	*	*	- - -

* A richiesta. - On request.

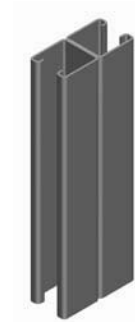
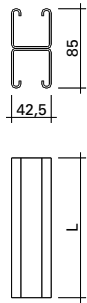

ELEMENTO | ELEMENT

CODICE | CODE

Descr.	L	Th	HDG	AISI 304	AISI 316	-
SV-D/42x42/3000	3000	2	SOVD3042	*	*	- - -
SV-D/42x42/6000	6000	2	SOVD6042	*	*	- - -

* A richiesta. - On request.

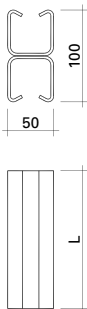

ELEMENTO | ELEMENT

CODICE | CODE

Descr.	L	Th	HDG	AISI 304	AISI 316	-
SV-D/50x50/3000	3000	3	SOVD3050	*	*	- - -
SV-D/50x50/6000	6000	3	SOVD6050	*	*	- - -

* A richiesta. - On request.

[sostegno orizzontale | horizontal support]

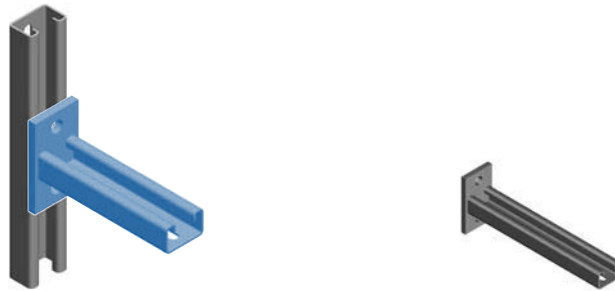
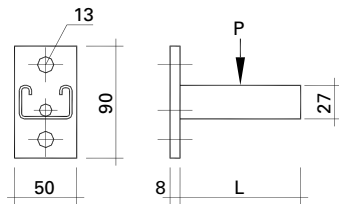

ELEMENTO | ELEMENT

CODICE | CODE

Descr.	L	(1) P	Th	HDG	AISI 304	AISI 316	-
SOF-50/27	97	3000	2	SOSO2701	*	*	- - -
SOF-100/27	147	3000	2	SOSO2702	*	*	- - -
SOF-200/27	247	2000	2	SOSO2704	*	*	- - -
SOF-300/27	347	1400	2	SOSO2706	*	*	- - -
SOF-400/27	447	1000	2	SOSO2708	*	*	- - -

(1) Coefficiente di sicurezza 2,5. - Safety coefficient of 2,5. * A richiesta. - On request.

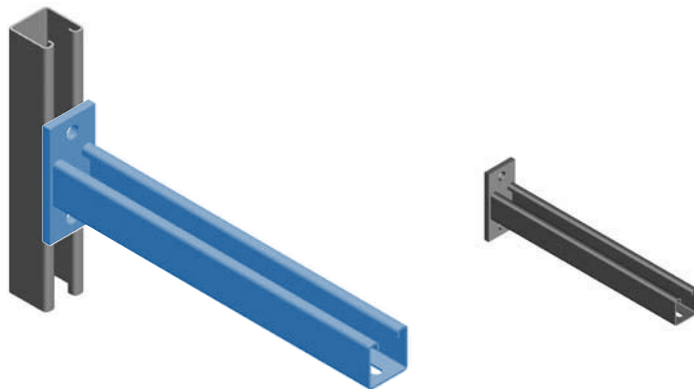
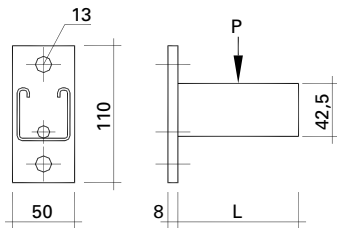

ELEMENTO | ELEMENT

CODICE | CODE

Descr.	L	(1) P	Th	HDG	AISI 304	AISI 316	-
SOF-300/42	347	2900	2	SOSO4206	*	*	- - -
SOF-400/42	447	2200	2	SOSO4208	*	*	- - -
SOF-500/42	547	1800	2	SOSO4210	*	*	- - -

(1) Coefficiente di sicurezza 2,5. - Safety coefficient of 2,5. * A richiesta. - On request.

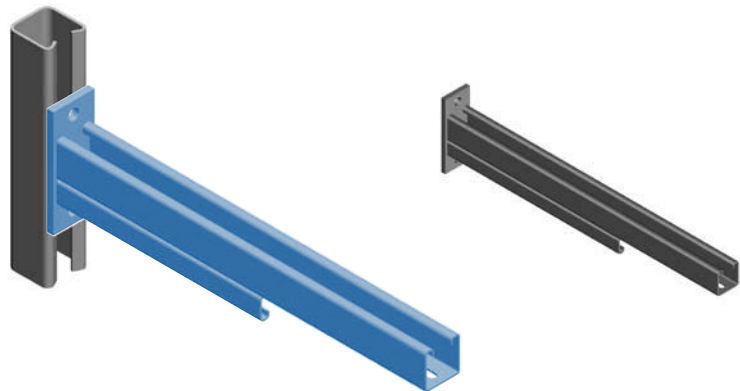
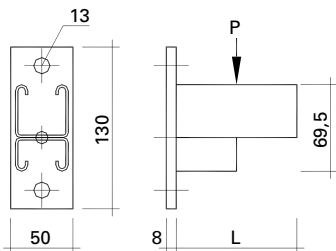

ELEMENTO | ELEMENT

CODICE | CODE

Descr.	L	(1) P	Th	HDG	AISI 304	AISI 316	-
SOF-400/69	447	5000	2	SOSO6908	*	*	- - -
SOF-500/69	547	4000	2	SOSO6910	*	*	- - -
SOF-600/69	647	3400	2	SOSO6912	*	*	- - -

(1) Coefficiente di sicurezza 2,5. - Safety coefficient of 2,5. * A richiesta. - On request.

[sostegno orizzontale | horizontal support]

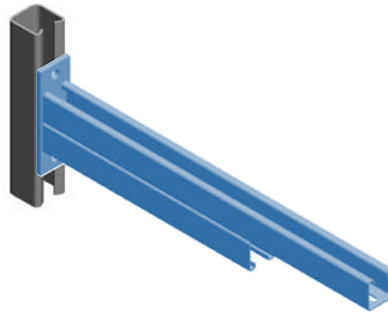
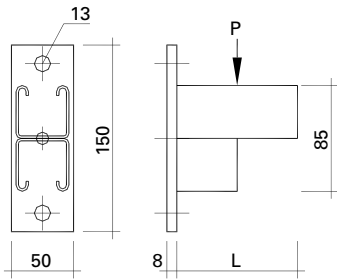

ELEMENTO | ELEMENT

CODICE | CODE

Descr.	L	(1) P	Th	HDG	AISI 304	AISI 316	-
SOF-500/84	547	5200	2	SOS08410	*	*	- - -
SOF-600/84	647	4300	2	SOS08412	*	*	- - -

(1) Coefficiente di sicurezza 2,5. - Safety coefficient of 2,5. * A richiesta. - On request.

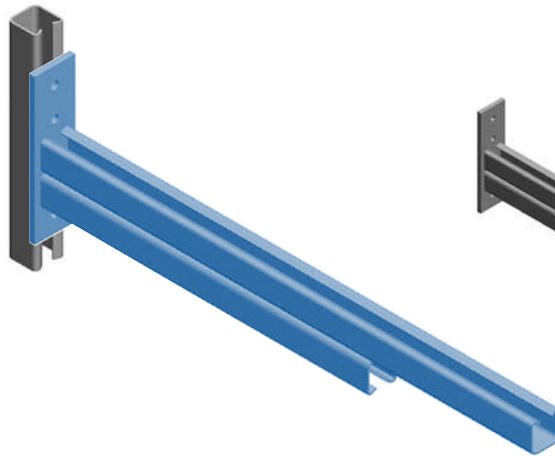
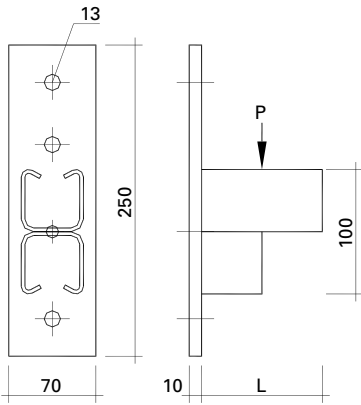

ELEMENTO | ELEMENT

CODICE | CODE

Descr.	L	(1) P	Th	HDG	AISI 304	AISI 316	-
SO-800/100	840	6000	3	SOS01016	*	*	- - -

(1) Coefficiente di sicurezza 2,5. - Safety coefficient of 2,5. * A richiesta. - On request.

[fissaggio sostegno verticale | vertical support fastener]

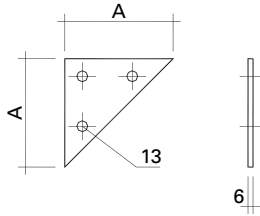

ELEMENTO | ELEMENT

CODICE | CODE

Descr.	A	HDG	AISI 304	AISI 316	-
FSV-CT/42	130	SOFS00CT	*	*	- - -
FSV-CT/50	155	SOFS50CT	*	*	- - -

* A richiesta. - On request.

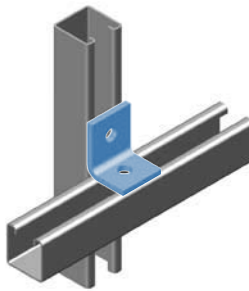
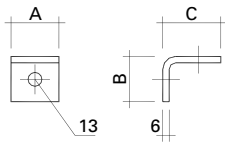

ELEMENTO | ELEMENT

CODICE | CODE

Descr.	A	B	C	HDG	AISI 304	AISI 316	-
FSV-SL/42	45	42,5	54,5	SOFS00SL	*	*	- - -
FSV-SL/50	50	50	62	SOFS50SL	*	*	- - -

* A richiesta. - On request.

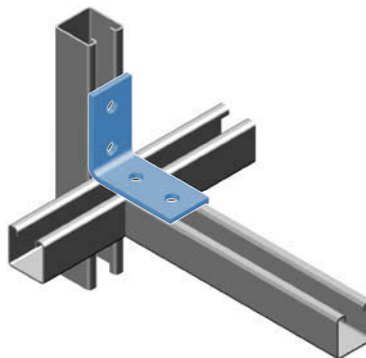
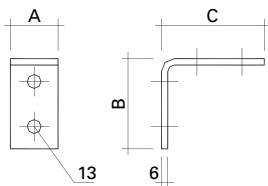

ELEMENTO | ELEMENT

CODICE | CODE

Descr.	A	B	C	HDG	AISI 304	AISI 316	-
FSV-DL/42	45	85	97	SOFS00DL	*	*	- - -
FSV-DL/50	50	100	112	SOFS50DL	*	*	- - -

* A richiesta. - On request.

[fissaggio sostegno verticale | vertical support fastener]

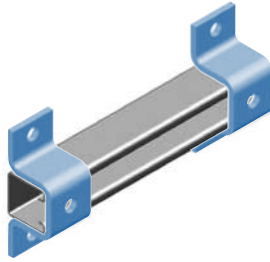
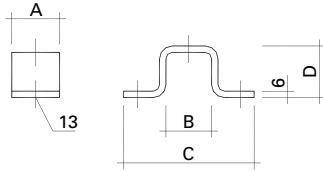

ELEMENTO | ELEMENT

CODICE | CODE

Descr.	A	B	C	D	HDG	AISI 304	AISI 316	-
FSV-SU/27	45	43	123	33	S0FS27SU	*	*	- - -
FSV-SU/42	45	43	123	48,5	S0FS42SU	*	*	- - -
FSV-SU/50	50	51	163	56	S0FS50SU	*	*	- - -

* A richiesta. - On request.

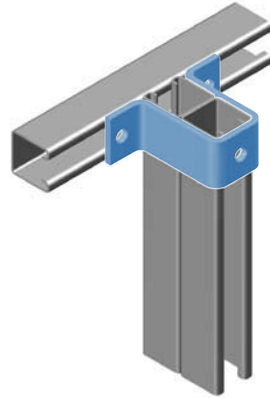
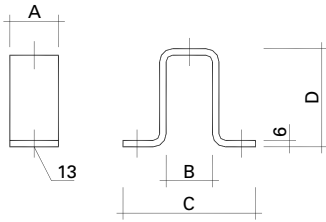

ELEMENTO | ELEMENT

CODICE | CODE

Descr.	A	B	C	D	HDG	AISI 304	AISI 316	-
FSV-DU/27	45	43	123	60	S0FS27DU	*	*	- - -
FSV-DU/42	45	43	123	91	S0FS42DU	*	*	- - -
FSV-DU/50	50	51	163	106	S0FS50DU	*	*	- - -

* A richiesta. - On request.

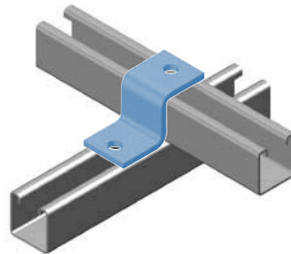
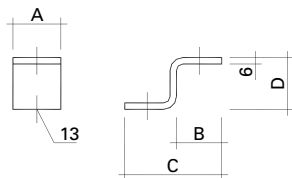

ELEMENTO | ELEMENT

CODICE | CODE

Descr.	A	B	C	D	HDG	AISI 304	AISI 316	-
FSV-SZ/27	45	42,5	91	33	S0FS27SZ	*	*	- - -
FSV-SZ/42	45	42,5	91	48,5	S0FS42SZ	*	*	- - -
FSV-SZ/50	50	50	106	56	S0FS50SZ	*	*	- - -

* A richiesta. - On request.

[fissaggio sostegno verticale | vertical support fastener]

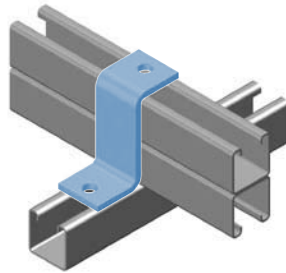
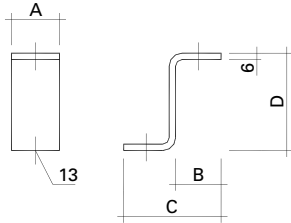

ELEMENTO | ELEMENT

CODICE | CODE

Descr.	A	B	C	D	HDG	AISI 304	AISI 316	-
FSV-DZ/27	45	42,5	91	60	SOFS27DZ	*	*	- - -
FSV-DZ/42	45	42,5	91	91	SOFS42DZ	*	*	- - -
FSV-DZ/50	50	50	106	106	SOFS50DZ	*	*	- - -

* A richiesta. - On request.

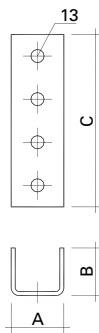

ELEMENTO | ELEMENT

CODICE | CODE

Descr.	A	B	C	HDG	AISI 304	AISI 316	-
FSV-SR/27	52	31	170	SOFS27SR	*	*	- - -
FSV-SR/42	52	47	170	SOFS42SR	*	*	- - -
FSV-SR/50	60	54	200	SOFS50SR	*	*	- - -

* A richiesta. - On request.

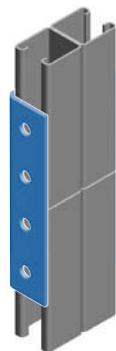
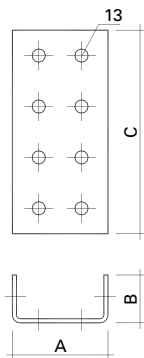

ELEMENTO | ELEMENT

CODICE | CODE

Descr.	A	B	C	HDG	AISI 304	AISI 316	-
FSV-DR/27	63	47	170	SOFS27DR	*	*	- - -
FSV-DR/42	94	47	170	SOFS42DR	*	*	- - -
FSV-DR/50	110	54	200	SOFS50DR	*	*	- - -

* A richiesta. - On request.

[fissaggio sostegno verticale | vertical support fastener]

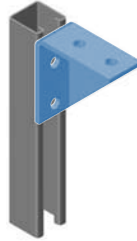
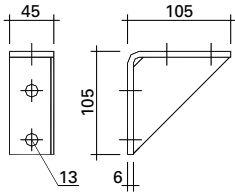

ELEMENTO ELEMENT		CODICE CODE			
Descr.	Th	HDG	AISI 304	AISI 316	-
FSV-D1	3	S0FS00D1	*	*	- - -

* A richiesta. - On request.

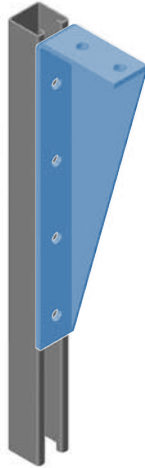
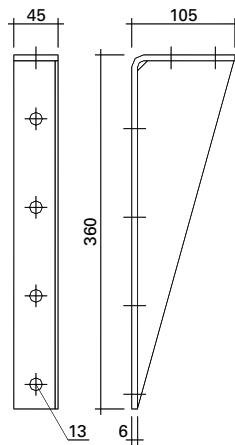

ELEMENTO ELEMENT		CODICE CODE			
Descr.	Th	HDG	AISI 304	AISI 316	-
FSV-D2	3	S0FS00D2	*	*	- - -

* A richiesta. - On request.

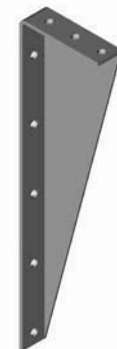
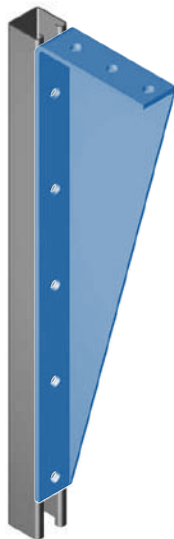
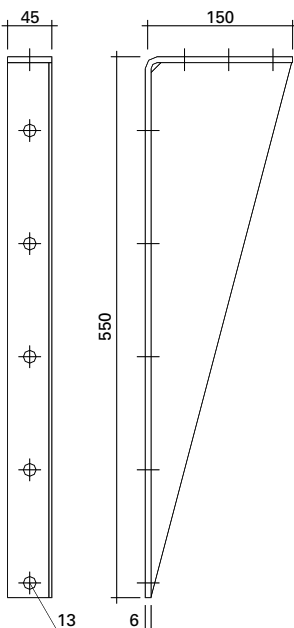

ELEMENTO ELEMENT		CODICE CODE			
Descr.	Th	HDG	AISI 304	AISI 316	-
FSV-D3	3	S0FS00D3	*	*	- - -

* A richiesta. - On request.

[fissaggio sostegno verticale | vertical support fastener]

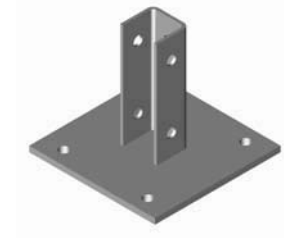
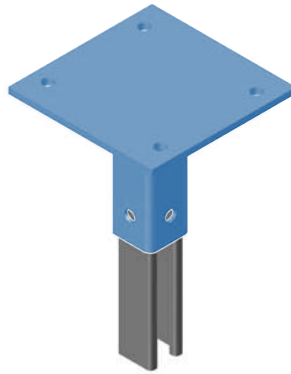
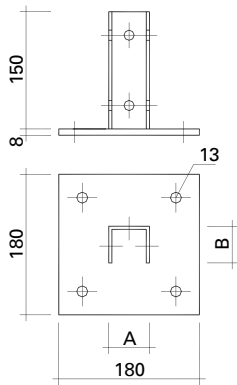

ELEMENTO | ELEMENT

CODICE | CODE

Descr.	A	B	Th	HDG	AISI 304	AISI 316	-
FSV-SP/27	52	31	4	S0FS27SP	*	*	- - -
FSV-SP/42	52	47	4	S0FS42SP	*	*	- - -
FSV-SP/50	60	54	4	S0FS50SP	*	*	- - -

* A richiesta. - On request.

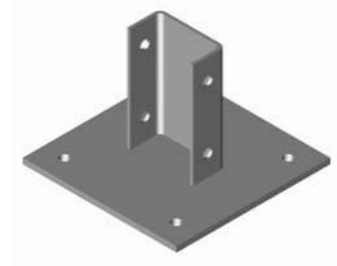
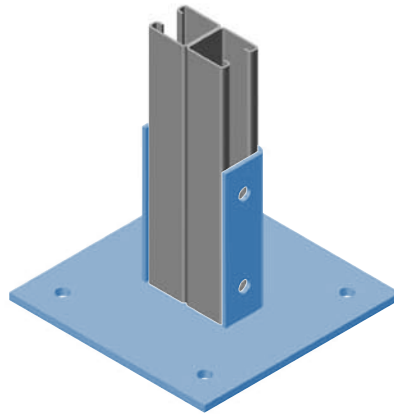
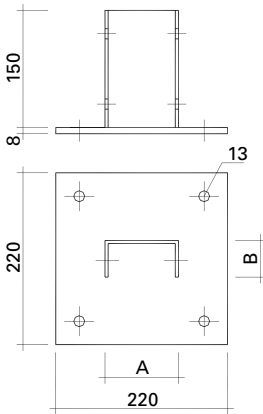

ELEMENTO | ELEMENT

CODICE | CODE

Descr.	A	B	Th	HDG	AISI 304	AISI 316	-
FSV-DP/27	63	31	4	S0FS27DP	*	*	- - -
FSV-DP/42	94	47	4	S0FS42DP	*	*	- - -
FSV-DP/50	107	54	4	S0FS50DP	*	*	- - -

* A richiesta. - On request.

[fissaggio sostegno verticale | vertical support fastener]

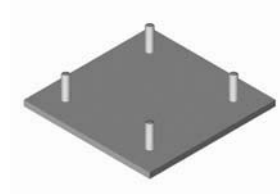
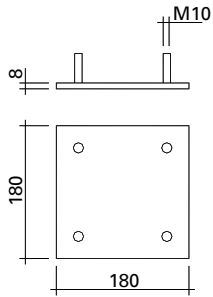

ELEMENTO | ELEMENT

CODICE | CODE

Descr.	GRE	AISI 304	AISI 316	-
FSV-SC	S0FS00SC	*	*	- - -

* A richiesta. - *On request.*

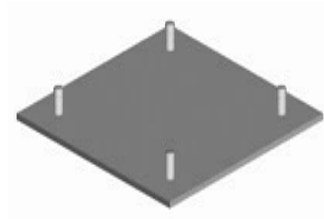
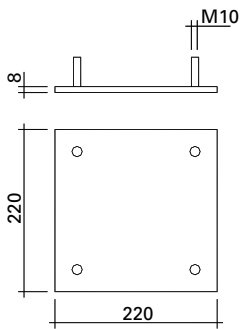

ELEMENTO | ELEMENT

CODICE | CODE

Descr.	GRE	AISI 304	AISI 316	-
FSV-DC	S0FS00DC	*	*	- - -

* A richiesta. - *On request.*

[staffa fissaggio tubi per PTR | pipe fixing brackets for PTR]

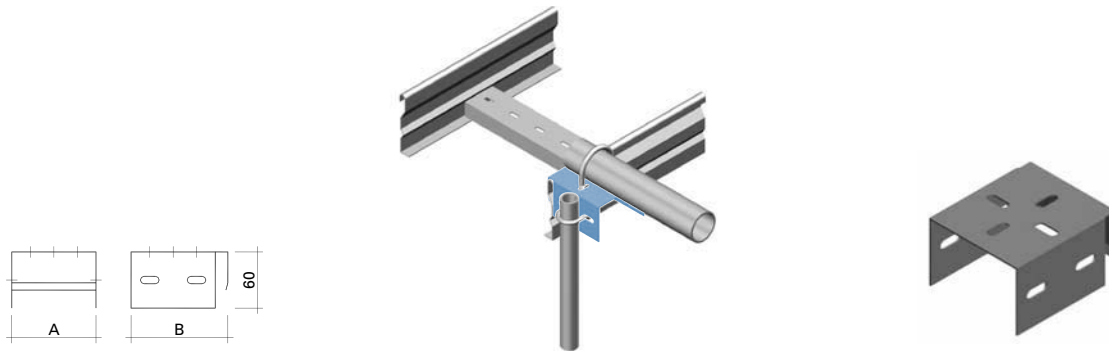

ELEMENTO | ELEMENT

CODICE | CODE

Descr.	A	B	Th	HDG	AISI 304	AISI 316	-
SSFT-1	90	105	1,5	SOFT0001	*	*	- - -
SSFT-2	170	185	1,5	SOFT0002	*	*	- - -

* A richiesta. - On request.

[staffa fissaggio tubi per PFR | pipe fixing brackets for PFR]

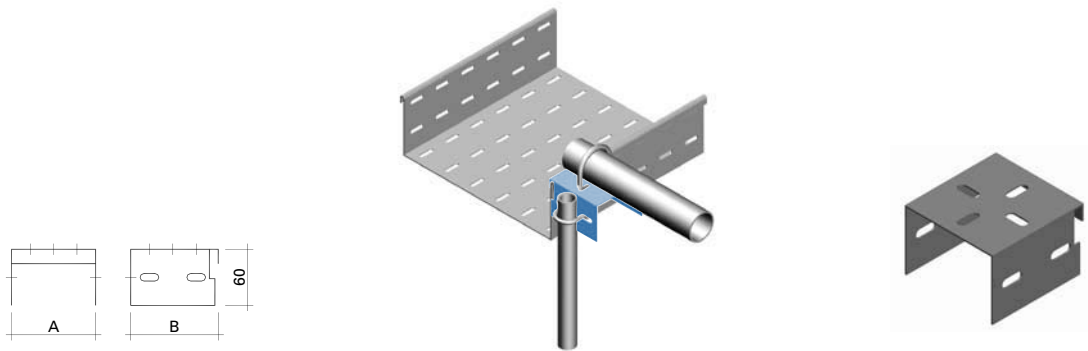

ELEMENTO | ELEMENT

CODICE | CODE

Descr.	A	B	Th	HDG	AISI 304	AISI 316	-
SSFT-3	90	95	1,5	SOFT0003	*	*	- - -
SSFT-4	170	175	1,5	SOFT0004	*	*	- - -

* A richiesta. - On request.

[staffa fissaggio tubi per PTR/PFS | pipe fixing brackets for PTR/PFS]

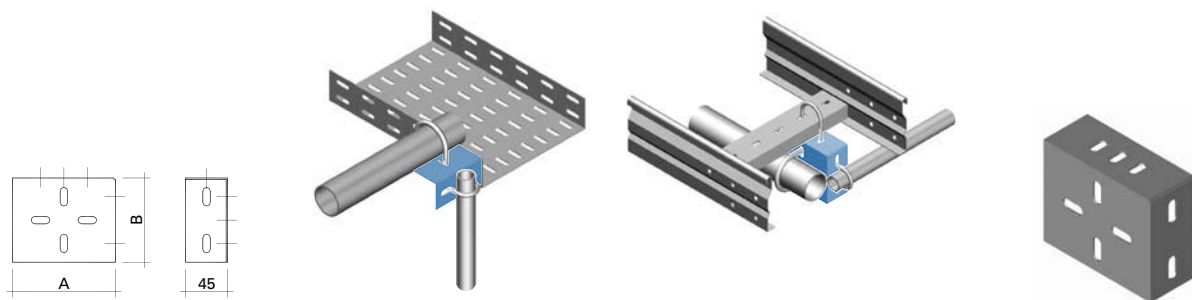

ELEMENTO | ELEMENT

CODICE | CODE

Descr.	A	B	Th	HDG	AISI 304	AISI 316	-
SIFT-1	110	90	1,5	SOFT0011	*	*	- - -
SIFT-2	170	170	1,5	SOFT0012	*	*	- - -

* A richiesta. - On request.

[morsetto fissatubo | pipe fastening clamp]

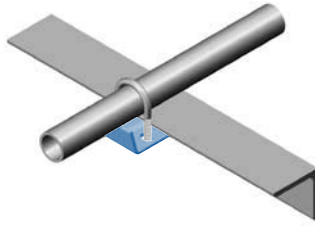
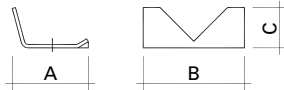

ELEMENTO ELEMENT	CODICE CODE						
Ø Tubo / Ø Conduit	A	B	C	EGS	AISI 304	AISI 316	-
1/2"-3/4"	55	50	29	TE070011	*	*	- - -
1"-1.1/4"	62	70	34	TE070013	*	*	- - -
1.1/2"-2"	68	90	39	TE070015	*	*	- - -

* A richiesta. - On request.

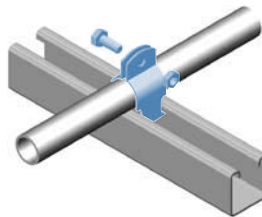
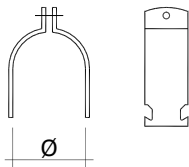

ELEMENTO ELEMENT	CODICE CODE			
Ø Tubo / Ø Conduit	EGS	AISI 304	AISI 316	-
1/2"	MV0200000ET04	*	*	- - -
3/4"	MV0200000ET05	*	*	- - -
1"	MV0200000ET06	*	*	- - -
1.1/4"	MV0200000ET07	*	*	- - -
1.1/2"	MV0200000ET08	*	*	- - -
2"	MV0200000ET09	*	*	- - -

* A richiesta. - On request.

[gaffetta | collar]

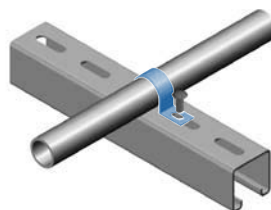
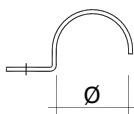

ELEMENTO ELEMENT	CODICE CODE			
Ø Tubo / Ø Conduit	EGS	AISI 304	AISI 316	-
1/2"	MV0200000GF1	*	*	- - -
3/4"	MV0200000GF2	*	*	- - -
1"	MV0200000GF3	*	*	- - -
1.1/4"	MV0200000GF4	*	*	- - -
1.1/2"	MV0200000GF5	*	*	- - -
2"	MV0200000GF6	*	*	- - -

* A richiesta. - On request.

[cavallotto | U bolt]

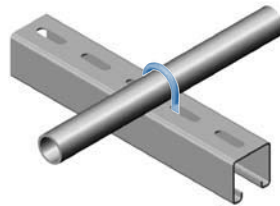
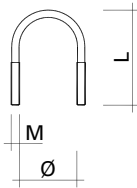

ELEMENTO | ELEMENT

CODICE | CODE

Ø Tubo / Ø Conduit	M	L	EGS	AISI 304	AISI 316	-
1/2"	6	58	MV0200000CL04	*	*	- - -
3/4"	6	62	MV0200000CL05	*	*	- - -
1"	6	70	MV0200000CL06	*	*	- - -
1.1/4"	6	78	MV0200000CL07	*	*	- - -
1.1/2"	8	90	MV0200000CL08	*	*	- - -
2"	8	102	MV0200000CL09	*	*	- - -

* A richiesta. - On request.

[piastrina per fissaggio piatto di terra | fixing plate for earth bar]

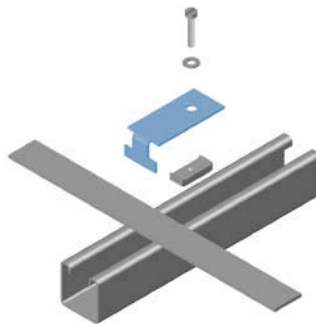
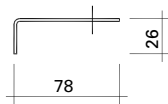

ELEMENTO | ELEMENT

CODICE | CODE

Descr.	Th	HDG	AISI 304	AISI 316	-
FR-405	2	*	SOFR0000	*	- - -

* A richiesta. - On request.

[bullone fissaggio sostegni | support fixing bolt]

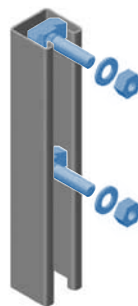
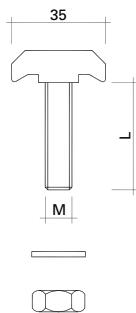

ELEMENTO | ELEMENT

CODICE | CODE

Descr.	M	L	HDG	AISI 304	AISI 316	-
Vite ad ancora/Anchor bolt	10	40	VZ1040	*	*	- - -
Rondella piana/Washer	-	-	VZRP10	*	*	- - -
Dado/Nut	-	-	VZDM10	*	*	- - -
Vite ad ancora/Anchor bolt	12	40	VZ1240	*	*	- - -
Rondella piana/Washer	-	-	VZRP12	*	*	- - -
Dado/Nut	-	-	VZDM12	*	*	- - -

* A richiesta. - On request.

[bullone fissaggio sostegni | support fixing bolt]

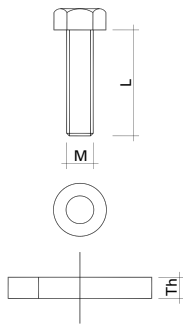

ELEMENTO ELEMENT	CODICE CODE		AISI 304	AISI 316	-
Descr.	M	L	HDG		
Vite/Screw	12	30	MC06TE0012030	*	- - -
Rondella piana/Washer	-	-	VZRP12	*	- - -
Dado ad ancora/Anchor nut	-	-	VZA012	*	- - -

* A richiesta. - On request.

[vite a testa esagonale | hexagon head screw]

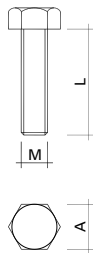

ELEMENTO ELEMENT	CODICE CODE				AISI 304	AISI 316	-
Descr.	M	L	A	EGS			
UNI 5737	6	20	10	MC01TE0006020	*	*	- - -
UNI 5737	6	40	10	MC01TE0006040	*	*	- - -
UNI 5737	6	60	10	MC01TE0006060	*	*	- - -
UNI 5737	8	20	13	MC01TE0008020	*	*	- - -
UNI 5737	8	40	13	MC01TE0008040	*	*	- - -
UNI 5737	8	60	13	MC01TE0008060	*	*	- - -
UNI 5737	10	40	17	MC01TE0010040	*	*	- - -
UNI 5737	10	60	17	MC01TE0010060	*	*	- - -
UNI 5737	10	80	17	MC01TE0010080	*	*	- - -
UNI 5737	10	100	17	MC01TE0010100	*	*	- - -
UNI 5737	12	40	19	MC01TE0012040	*	*	- - -
UNI 5737	12	60	19	MC01TE0012060	*	*	- - -
UNI 5737	12	80	19	MC01TE0012080	*	*	- - -
UNI 5737	12	100	19	MC01TE0012100	*	*	- - -

Nota/Note: altre misure a richiesta - other dimensions on request. * A richiesta. - On request.

[rondella piana | washer]



ELEMENTO ELEMENT	CODICE CODE				AISI 304	AISI 316	-
Descr.	D	d	Th	EGS			
UNI 6592	12	6,4	1,6	MC01RP0006000	*	*	- - -
UNI 6592	16	8,4	1,6	MC01RP0008000	*	*	- - -
UNI 6592	20	10,5	2	MC01RP0010000	*	*	- - -
UNI 6592	24	13	2,5	MC01RP0012000	*	*	- - -

Nota/Note: altre misure a richiesta - other dimensions on request. * A richiesta. - On request.

[rondella elastica | serrated lock washer]



ELEMENTO | ELEMENT

CODICE | CODE

Descr.	D	d	Th	EGS	AISI 304	AISI 316	-
UNI 1751-A	11,8	6,1	1,6	MC01RG0006000	*	*	- - -
UNI 1751-A	14,8	8,1	2	MC01RG0008000	*	*	- - -
UNI 1751-A	18,1	10,2	2,2	MC01RG0010000	*	*	- - -
UNI 1751-A	21,1	12,2	2,5	MC01RG0012000	*	*	- - -

Nota/Note: altre misure a richiesta - other dimensions on request. * A richiesta. - On request.

[dado | nut]

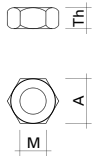

ELEMENTO | ELEMENT

CODICE | CODE

Descr.	M	Th	A	EGS	AISI 304	AISI 316	-
UNI 5588	6	5	10	MC01DM0006000	*	*	- - -
UNI 5588	8	6,5	13	MC01DM0008000	*	*	- - -
UNI 5588	10	8	17	MC01DM0010000	*	*	- - -
UNI 5588	12	10	19	MC01DM0012000	*	*	- - -

Nota/Note: altre misure a richiesta - other dimensions on request. * A richiesta. - On request.

[barra filettata | threaded rod]

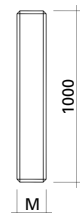

ELEMENTO | ELEMENT

CODICE | CODE

Descr.	M	EGS	AISI 304	AISI 316	-
DIN 975	6	MC01BF0006000	*	*	- - -
DIN 975	8	MC01BF0008000	*	*	- - -
DIN 975	10	MC01BF0010000	*	*	- - -
DIN 975	12	MC01BF0012000	*	*	- - -

Nota/Note: altre misure a richiesta - other dimensions on request. * A richiesta. - On request.

[tassello ad espansione | screw anchor]

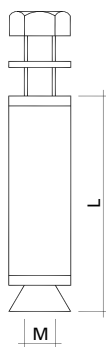

ELEMENTO | ELEMENT

CODICE | CODE

Descr.	M	L	HDG	-	-	-
	6	40	MV020000SLM6	-	-	-
	8	55	MV020000SLM8	-	-	-
	10	65	MV020000SLM10	-	-	-
	12	80	MV020000SLM12	-	-	-

Nota/Note: altre misure a richiesta - other dimensions on request.

[vernice per ritocchi a base di zinco | touch-up paint of zinc]

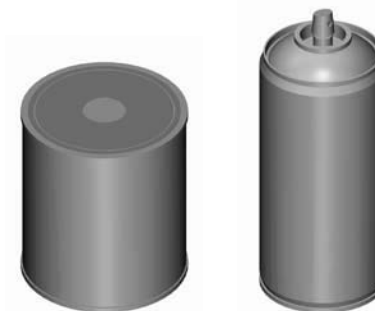

ELEMENTO | ELEMENT

CODICE | CODE

Descr.	kg	HDG	-	-	-
Liquido/liquid	1	MD060ZINCANTE	-	-	-
Spruzzo/Spray	0.4	MD06SPRZI0400	-	-	-

[piatto | plate]

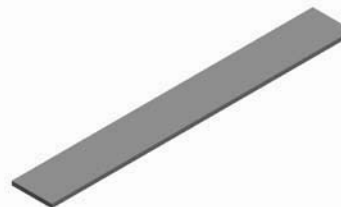
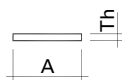

ELEMENTO | ELEMENT

CODICE | CODE

Descr.	A	Th	HDG	-	-	-
UNI 6014 30x3	30	3	FPZM00P303	-	-	-
UNI 6014 40x4	40	4	FPZM00P404	-	-	-
UNI 6014 50x5	50	5	FPZM00P505	-	-	-
UNI 6014 60x6	60	6	FPZM00P606	-	-	-

Nota/Note: altre misure a richiesta - other dimensions on request.

[angolare | equal angular]

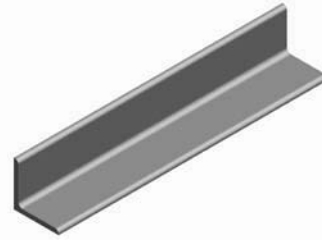
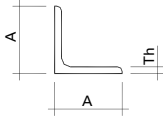

ELEMENTO | ELEMENT

CODICE | CODE

Descr.	A	Th	HDG	-	-	-
UNI 5783 30x3	30	3	FPZM00A303	-	-	-
UNI 5783 40x4	40	4	FPZM00A404	-	-	-
UNI 5783 50x5	50	5	FPZM00A505	-	-	-
UNI 5783 60x6	60	6	FPZM00A606	-	-	-

Nota/Note: altre misure a richiesta - other dimensions on request.

[ferro ad "U" | U iron]

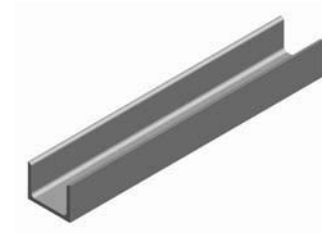
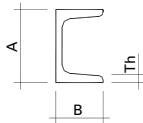

ELEMENTO | ELEMENT

CODICE | CODE

Descr.	A	B	Th	HDG	-	-	-
UNI 5786 30x15x5	30	15	5	FPZM000U30	-	-	-
UNI 5680 50x38x5	50	38	5	FPZM000U50	-	-	-
UNI 5680 65x42x5,5	65	42	5,5	FPZM000U65	-	-	-
UNI 5680 80x45x6	80	45	6	FPZM000U80	-	-	-

Nota/Note: altre misure a richiesta - other dimensions on request.

[tubo conduit | conduit]

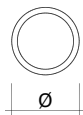

ELEMENTO | ELEMENT

CODICE | CODE

Descr.	Ø	HDG	-	-	-
AD-PE UNI 7683 1/2"	1/2"	FTCZM00021	-	-	-
AD-PE UNI 7683 3/4"	3/4"	FTCZM00027	-	-	-
AD-PE UNI 7683 1"	1"	FTCZM00033	-	-	-
AD-PE UNI 7683 1.1/2"	1.1/2"	FTCZM00048	-	-	-
AD-PE UNI 7683 2"	2"	FTCZM00060	-	-	-

Nota/Note: altre misure a richiesta - other dimensions on request.

